

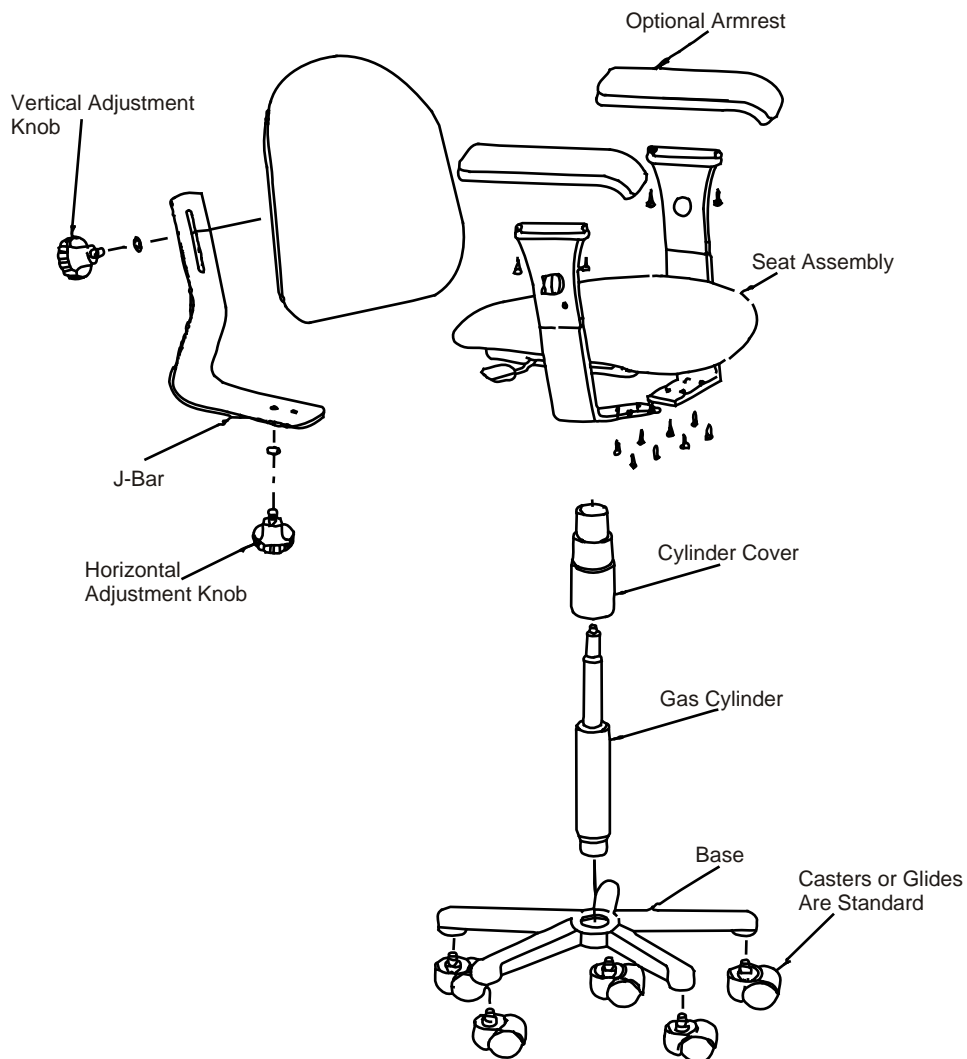

ERGO PRO CHAIR - EC SERIES ASSEMBLY INSTRUCTIONS

- STEP 1 Snap glides or casters into legs
- STEP 2 Place gas cylinder down into base
- STEP 3 Place cylinder cover over cylinder
- STEP 4 Place seat assembly down onto the base assembly
- STEP 5 Attach J-Bar to seat and back using the two adjustment knobs with washers



assembl5.pdf

603 Meacham Road - P O Box 6029 - Statesville, NC 28687
Phone 704-872-0300 - Toll Free 1-800-822-5376 - Fax 704-872-4194